

090-102-3

January 1956

OPERATING INSTRUCTIONS  
FOR  
TELEVISION PEDESTAL  
MODEL PD-3

MANUFACTURED BY

HOUSTON FEARLESS

Division of Color Corporation of America

11801 WEST OLYMPIC BOULEVARD

LOS ANGELES 64, CALIFORNIA

## TABLE OF CONTENTS

SECTION		PAGE NO.
I.	DESCRIPTION .....	1
	I. General Description .....	1
	A. Functional .....	1
	1. Synchronous Steering .....	1
	2. Tricycle Steering .....	2
	II. Detailed Description .....	3
	A. Specifications .....	3
	B. Counter-Weighted Rising Column ..	3
	C. Drag and Locks .....	4
	D. Steering Mechanism .....	4
	E. Cable Guards .....	5
	F. Safety Lock .....	5
	G. Storage Compartments .....	6
	H. Column Head .....	6
II	OPERATION .....	7
	I. Preparation for use .....	7
	A. Installing Friction Head .....	7
	B. Counterbalancing .....	7
	II. Operation .....	8
	A. Using Drag and Lock .....	8
	B. Steering .....	8
	C. Adjusting Cable Guards .....	9
	D. Step Plates .....	10
	III. Removing the Camera .....	10

090-102-3

W A R N I N G

CAUTION

NEVER UNLOCK THE SAFETY LOCK WHEN THE  
CAMERA IS REMOVED FROM THE PEDESTAL.  
THE COUNTER-WEIGHTS WILL CAUSE THE RIS-  
ING COLUMN TO RISE RAPIDLY, AND POSSIBLY  
INJURE THE OPERATOR.

SECTION I  
DESCRIPTION

I. GENERAL DESCRIPTION.

A. FUNCTIONAL. - The Houston Fearless Television Pedestal Model PD-3 is designed to mount a Houston Fearless friction head, or other standard friction head, and a black and white television camera. It is designed for one-man operation. It acts as a firm stable mount for the camera, resulting in better, steadier pictures. It also provides complete mobility for smooth-running dolly shots and for raising and lowering the camera during operation. The rising column on which the camera is mounted is counterbalanced so that the camera is easily raised or lowered simply by pushing up or down on the steering wheel or camera. No cranking is required. The steering wheel, which is located directly below the camera at all heights, guides the three sets of dual wheels, one in each apex of the triangular base. The wheels are equipped with ball bearings for smooth, silent operation. Two types of steering are available, and by operating a foot pedal on the base of the pedestal, either may be chosen by the operator while the camera is on the air. The two types of steering are:

1. SYNCHRONOUS STEERING, in which all wheels are locked parallel and turn simultaneously. This type of steering is best for tracking in straight line. By operating the

hand wheel and observing the positioning arrow on one of the spokes of the wheel, the operator can set the direction of the wheels before the pedestal is in motion. The pedestal will then travel in the direction indicated by the arrow.

2. TRICYCLE STEERING, in which the forward wheel only is steered. The back wheels are locked parallel. This enables the pedestal to follow a curved course and to turn sharply in any direction.

A drag clutch is provided so that, by turning a control wheel below the steering wheel, the drag on the rising column can be adjusted until it is loaded to suit the operator's individual preference. This drag brake can also be adjusted to lock the rising column, to provide any degree of drag desired, or to make the column absolutely free-running. An auxiliary lock is provided so that, when the pedestal column is in its lowest position, the camera may be removed and the counter-weights will not raise the rising column. The height range of the pedestal is from 36 inches to 57 inches, excluding the height of the friction head and the camera. Additional camera weights, such as large lenses, lights, and so forth, are easily compensated for by adding additional counter-weights which are furnished with the pedestal.

Non-slip step plates are provided on the corners of the triangular base on which the cameraman can stand when the camera is in the raised position. These plates are removable to allow for storage of tools and weights in compartment under the plates. The base of the pedestal is of arc-welded steel. The center column is seamless steel tubing. The trim and steering wheel are satin-chrome finish. All bearings in the equipment are packed and sealed at the factory, so no lubrication is required.

II. DETAILED DESCRIPTION.

A. SPECIFICATIONS. - The specifications of the equipment are as follows:

Maximum Height (not including friction head) - 57 inches

Minimum Height (not including friction head) - 36 inches

Maximum Width - 38-1/4 inches

Minimum Width - 34-1/2 inches

Weight - 596 pounds

Shipping Weight - 750 pounds

(Friction Head is not included with pedestal).

B. COUNTER-WEIGHTED RISING COLUMN. - The counter-weighted column consists of a seamless steel tube that is raised and lowered inside of a larger, fixed seamless steel

tube. It is held rigidly in position by two sets of three rollers, 120° apart, which guide and align the rising column. A rubber pad is provided at the center of the column so that the column will settle softly when it is moved to its lowest position. Three steel cables run from the bottom of the inside column and over three pulleys at the top of the outside column. They are attached to a carrier which holds the lead counter-weights. The lead counter-weights fall and rise inside the housing as the camera is raised or lowered. The housing may be easily removed so that additional counter-weights may be added when lenses are changed, or lights, etc., are added or taken off the camera.

C. DRAG AND LOCKS. - A smaller control wheel located just above the counter-weight housing is used to apply drag and braking action to the vertical movement of the column. Three brake shoes are provided, located 120° apart, around the column. As the wheel is turned, an eccentric action increases or reduces the brake shoe pressure against the rising column. This wheel can be reached by the operator from any position around the pedestal. It enables him to lock the pedestal at any height, or to apply any degree of drag he may desire during operation.

D. STEERING MECHANISM. - A large wheel is provided just below the mount for the friction head. Turning this wheel steers the pedestal in the direction shown by an arrow on one of the spokes of the wheel. An index arrow is provided on the fixed column top so that when the two arrows

are aligned, the pedestal will move straight forward. Operating this wheel drives a gear shaft extending down through the center column of the pedestal. Since this shaft is telescoping, steering operation is available regardless of the height of the pedestal. The wheels are steered by a chain and sprocket arrangement operating directly from the base of this telescoping shaft. Two types of steering are provided, and a foot pedal enables either type to be chosen by the operator while the camera is on the air. The chain drive is directly to the front wheel of the triangular base. When the arrow on the wheel and column are in line, and the STEER 3 pedal is depressed, all of the wheels are connected by the chain. Consequently, when the steering wheel is turned, all three wheels move in synchronism and remain parallel. This type of steering permits the pedestal to move in a straight line in any direction. When the arrows are aligned and the STEER 1 pedal is depressed, the two rear wheels are de-clutched from the chain drive and locked in their fixed positions. The steering then only operates on the front set of dual wheels and is of the tricycle type. It enables the operator to turn the pedestal sharply in any direction, and to steer any course that the programming demands. The wheels are equipped with ball bearings.

E. CABLE GUARDS. - Cable guards are provided all around the triangular base to prevent the wheels from run-



ning into cables. These guards have slotted holes and are adjustable to any height above the floor by lock screws.

F. SAFETY LOCK. - A safety lock is provided to hold the pedestal in its lowest position when the camera is removed. This permits changing the camera without having the pedestal column rise due to the counter-weights. The lock consists of a spring-loaded pin and detent combination. To lock the column in its downward position, the pin goes through two aligned holes in the two columns.

G. STORAGE COMPARTMENTS. - The three-cornered step plates, one on each apex of the triangular base, are removable. A storage compartment is provided beneath each plate. This compartment can be used for storing weights, tools, and other operating items. Normally, weights selected to be placed in these compartments will be those which will counter-balance added lenses, lights, and other items, so these weights will be readily available when necessary.

H. COLUMN HEAD. - The head of the rising column is equipped to mount the Houston Fearless Friction Head, or other standard friction head. The heads may be easily attached or removed, as the mounting nut is installed through openings in the side of the column.

SECTION II  
OPERATION

CAUTION

NEVER UNLOCK THE SAFETY LOCK WHEN THE CAMERA IS REMOVED FROM THE PEDESTAL. THE COUNTER-WEIGHTS WILL CAUSE THE RISING COLUMN TO RISE RAPIDLY AND POSSIBLE INJURE THE OPERATOR.

I. PREPARATION FOR USE.

A. INSTALLING FRICTION HEAD. - Install the friction head at the top of the rising column by removing the lock nut from the head. Place the head in the circular hole in the top of the column and insert the lock nut through the opening in the side of the column. Attach and tighten the nut.

B. COUNTERBALANCING. - Install the camera with lenses and other equipment on the friction head. If practical, tie the camera cable to one point of the pedestal, allowing a loop of sufficient length to permit full movement up and down. This is to permit better balancing and to keep the cable free of the wheels. Remove the housing from around the weight carriage. Release the safety lock and add

weights from the stock of weights supplied, until the camera can be raised and will stay in any position when no drag is placed on the column. Notice that the weights are supplied in varying degrees of thickness. Various combinations should be employed to produce exact balance. When placing the weights on the carriage, distribute them evenly around the center column to prevent any undue strain on any of the three steel cables. With the camera and equipment in perfect balance, replace the housing around the weight carriage.

## II. OPERATION.

A. USING DRAG AND LOCK. - With the camera balanced adjust the drag wheel just above the counter-weight housing until the rise and fall of the camera seems to have the proper "stiffness" to suit the individual operator. There is no standard adjustment of this, since each operator will have his own preference as to the setting. To lock the pedestal at any height, turn this wheel to the lock position. All of these adjustments, or variations of them, may be made by the operator while the camera is on the air.

B. STEERING. - The large wheel just below the tripod mount is turned to direct the wheels as desired by the operator. This is easily done while the pedestal is in any

position, as the operator normally operates the panning arm with one hand and moves and steers the pedestal with the other. The arrow on one of the spokes of the wheel indicates the direction in which the wheels are turned and the direction in which the pedestal may be expected to move when it is pushed by the operator. When synchronous steering is desired, align the arrow on the wheel with the arrow on the column and depress the STEER 3 pedal, on the back of the pedestal base. Operating the hand wheel will then turn all three sets of wheels simultaneously. The sets of wheels will remain parallel. This enables the pedestal to move in a straight line in any direction from its resting position. When the arrows are aligned and the STEER 1 pedal is depressed, the front wheel is steered as the front wheel of a tricycle, and the pedestal may be moved on a curved path determined by the setting of the steering wheel.

C. ADJUSTING CABLE GUARDS. - The cable guards are provided to push away cables as the pedestal is moved, so as to prevent the cables from jamming the pedestal or rocking the camera as it rolls over them. These cable guards are adjustable. On a level floor, they may be set so that they are barely above floor level. On uneven surfaces, make a slightly higher adjustment. The cable guards are equipped with slotted holes so that they may be moved up and down, and are fastened in position by screws.

D. STEP PLATES. - The step plates on the three apexes of the triangular base are equipped with non-skid surfaces so that the operator may stand on them if necessary when operating the camera in its maximum height position. These plates may be moved, so that spare weights, tools, etc., may be stored in the compartments beneath them. When replaced, they are held in position by one screw so that they will be immovable when the operator is standing on them.

### III. REMOVING THE CAMERA

To remove the camera, place the pedestal in its lowest position and adjust the spring-loaded safety lock, found in the depression in the top hood over the weight carriage, so that the locking pin is in its farthest "in" position. It then engages the two holes, one in the outer and one in the inner columns. When the safety lock is engaged, the camera may be removed and the lock will prevent the rising column from moving up due to the counter-weights.

080-102-2

(Replaces 080-102-1)

PARTS LIST

HOUSTON-FEARLESS TELEVISION PEDESTAL

TYPE PD-3  
(Serial No. 20 and Up)

THE HOUSTON-FEARLESS CORPORATION

LOS ANGELES 64, CALIFORNIA

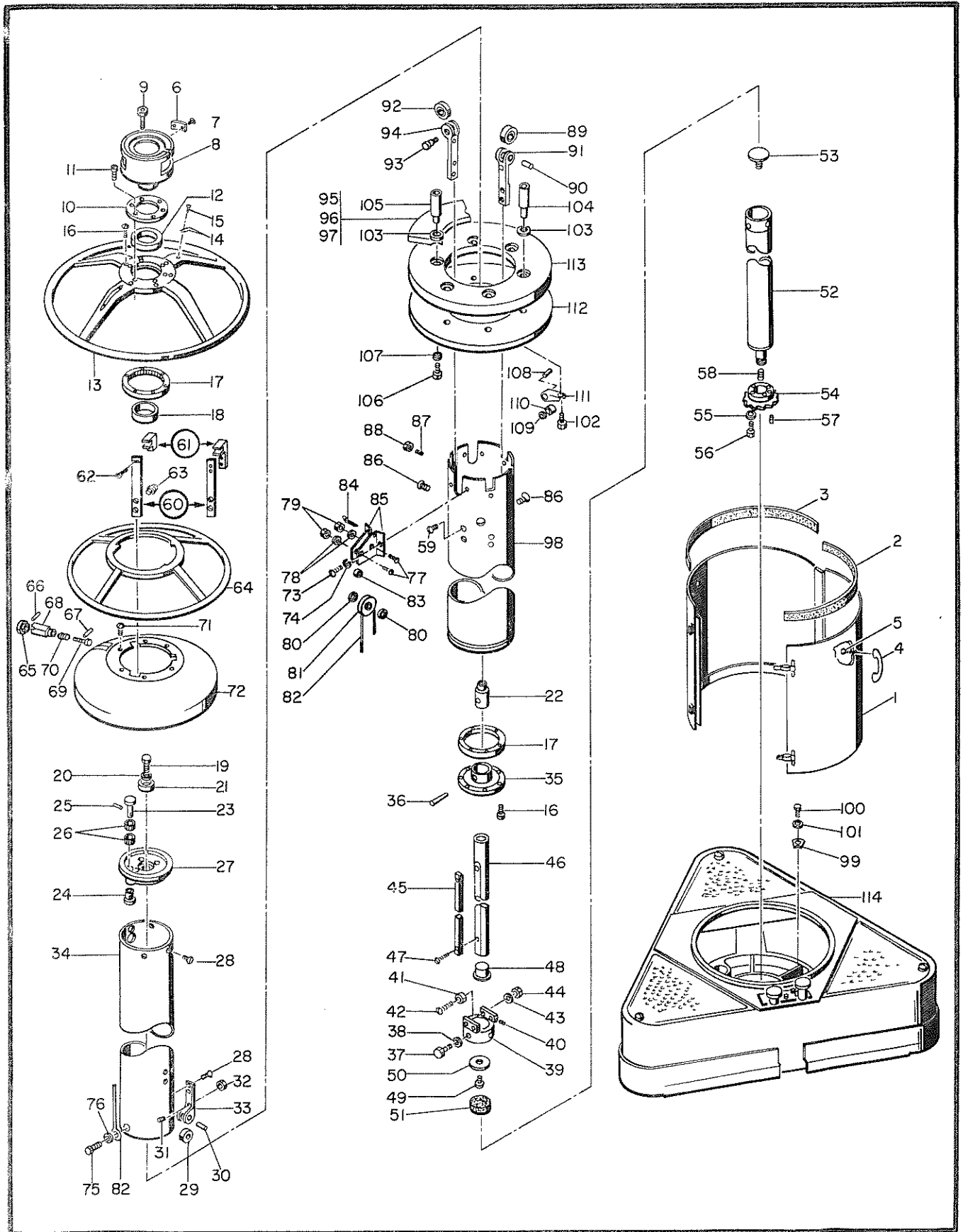

FIGURE I. HOUSTON-FEARLESS TYPE PD-3 TELEVISION PEDESTAL, EXPLODED VIEW, UPPER SECTION

HOW TO ORDER PARTS FOR THE  
HOUSTON-FEARLESS PD-3  
TELEVISION PEDESTAL  
(Serial Nos. 20 and Subsequent)

When ordering parts please provide the serial number of the pedestal for which the part is ordered, or if for general stock, please so note on the purchasing instructions.

Index numbers are assigned to parts and assemblies in ascending order in accordance with a logical disassembly procedure. A few exceptions to this will be found in cases where it is necessary to group parts of a single sub-assembly.

Parts may be ordered individually, or in assemblies or sub-assemblies by part number as indicated on the exploded view and the parts list. To locate a part, refer to the exploded view, and locate the part desired by the index number on the drawing. Refer to the index number in the parts list, and locate the Houston-Fearless part number opposite it in the second column. Use this number for ordering. The part description is in the third column. The fourth column gives the number of times the part appears in the next higher assembly. The number of times the part will appear in the equipment in a similar manner will be found by locating the next higher assembly and multiplying the number of times the part appears by the number of times the assembly appears.

To locate the next higher assembly, first locate the part as previously described. If the part description (third column) is



indented three positions (. . .) trace backwards up the list to the next item indented two positions (. .). This will be the next higher assembly. Assemblies are identified in two ways, where the assembly is provided with an index number, examples:

1-13      3010830                      . . Steering Wheel Assembly . . . 1,

the figure and index number (1-13) in the first column indicates the entire assembly and the next two parts, index (1-14) and (1-15) are available separately for replacement. The wheel without parts (1-14) and (1-15) is not available separately. Where the assembly is not provided with an index number for example: (following index 1-28) "\_\_\_\_\_ 2010850-1                      . . Roller Assembly, Tube Guide . . . 3", the entire assembly may be ordered as "Assembly 2010850-1", or any one of the individual part, index numbers (1-29), (1-30), (1-31), (1-32), (1-33), may be ordered separately. Note that three such assemblies are required per pedestal. In order, for example, to replace all the rollers, index (1-29) 2010852-1 it is necessary to find the number per assembly, and then multiply this by the number of assemblies in the pedestal, providing a total of 3.

N O T E

Where parts are applicable only to Pedestals Serial Nos. 20 to 49 inclusive, an asterisk is placed following the part number. Two asterisks (\*\*) indicate that the parts are applicable to Pedestals Serial Nos. 50 and subsequent. Part numbers without asterisks are applicable to all Pedestals, Serial Nos. 20 and subsequent.

Fig. & Index No.	Part No.	DESCRIPTION							NO. REQUIRED PER ASSEMBLY
		1	2	3	4	5	6	7	
1-	5010700	Pedestal PD-3, Complete Assembly							1
1-1	4010807	. Outer Casing Assembly							1
1-2	4010807-3	. . Felt Strip							2
1-3	4010807-4	. . Felt Strip							2
1-4	4010807-101	. . Handle							2
1-5	4010807-104	. . Screw, Cd. plate, No. 8-32 NC2 x 5/16 in. long							4
1-6	1010864	. Plate, Instruction							1
1-7	5010700-119	. Drive Screw, No.4							2
	5010828	. Inner Column Assembly							1
1-8	4010827	. . Pan Head Mount							1
1-9	4010828-117	. . Screw, Socket Hd., 5/16-18NC -2 x 1-3/4 in. long							4
1-10	3010834	. . Bearing Retainer							1
1-11	5010828-118	. . Screw, Fillister Hd., No. 10-32NF-2 x 5/8 in. long							6
1-12	5010828-102	. . Ball Bearing							1
1-13	3010830	. . Steering Wheel Assembly							1
1-14	1010779	. . . Indicator, Direction							1
1-15	3010830-101	. . . Drive Screw No. 0							2
1-16	5010828-101	. . Screw, Rd. Hd, No. 10-32NC -2 x 3/4 in. long							12
1-17	3010833	. . Ring Gear, Steering							2
1-18	2010836	. . Sleeve, Pan Head Mounting							1
1-19	5010828-119	. . Hex Head Cap Screw, 3/8-16NC 2 x 5/8 in. long							1

## 080-102-2

Fig. & Index No.	Part No.	DESCRIPTION							NO. REQUIRED PER ASSEMBLY
		1	2	3	4	5	6	7	
1-20	5010828-120	.	.					Washer, Plain, 3/8	1
1-21	5010828-103	.	.					Ball bearing	1
1-22	2010857	.	.					Plug, steering column	1
1-23	2010837	.	.					Pinion, ring gear, top	1
1-24	2010838	.	.					Pinion, ring gear, bottom	1
1-25	5010828-122	.	.					Taper pin, #000, 9/16 in. lg	1
1-26	5010828-104	.	.					Needle bearing	2
1-27	4010829	.	.					Top Plate, inner column	1
1-28	5010828-109	.	.					Screw, flat head, 1/4-20 NC2 x 5/8 in. lg	12
	2010850-1	.	.					Roller Assembly, tube guide	3
1-29	2010852-1	.	.	.				Roller	1
1-30	1010860	.	.	.				Pin, roller	1
1-31	3010850-101	.	.	.				Set screw, cup point 1/4- 28 NF2 x 1/2 in. lg	1
1-32	3010850-102	.	.	.				Nut, hex, 1/4-28 NF2	1
1-33	2010854-1	.	.	.				Bracket	1
1-34	4010788	.	.					Column, inner	1
1-35	3010835	.	.					Support, ring gear	1
1-36	5010828-116	.	.					Taper pin, No. 4, 3 in. lg	1
1-37	5010828-113	.	.					Bolt, hex hd, 1/4-28 NF2 x 3/8 in. lg	3
1-38	5010828-114	.	.					Lock washer, 1/4 in.	3
1-39	2010721	.	.					Steering tube cap	1

Fig. & Index No.	Part No.	DESCRIPTION							NO. REQUIRED PER ASSEMBLY
		1	2	3	4	5	6	7	
1-40	5010828-124*	.	.					Set Screw, socket hd, No. 10-24 x 1/4 in. lg	4
1-41	5010828-108	.	.					Ball Bearing	4
1-42	5010828-110	.	.					Bolt, Clevis, AN24-6	4
1-43	5010828-112	.	.					Washer, 1/4 in.	4
1-44	5010828-111	.	.					Nut, Elastic stop 1/4-28	4
	3010818	.	.					Column Assy, Inner steering	1
1-45	3010819-1	.	.	.				Key, Steering	2
1-46	3010819-2	.	.	.				Tube, Steering	1
1-47	3010819-101	.	.	.				Screw, Flat hd, No. 8-32 NC-2 x 1/2 in. lg	6
1-48	2010820*	.	.	.				Plug Assembly, Lower inner	1
	2010859**	.	.	.				Plug Assembly, Lower inner	1
1-49	2010858-102	.	.	.	.			Screw, Rd hd, 1/4 -20 NC2 x 5/16	1
1-50	2010858-1	.	.	.	.			Guide	1
1-51	5010828-121	.	.					Bumper, Rubber	1
1-52	2010817	.	.					Column, Steering, outer	1
1-53	2010868**	.	.					Plate, Adjusting, bottom	1
1-54	2010816	.	.					Sprocket, Steering column	1
1-55	5010828-107	.	.					Washer, Lock, No. 10	4
1-56	5010828-106	.	.					Screw, Rd hd, No. 10-32 NC-2 x 1 in. lg	4
1-57	5010828-115	.	.					Pin, Taper, No. 3 x 1-1/8 in. lg	1

\* Pedestals Serial Nos. 20 to 49 Inclusive  
 \*\* Pedestals Serial Nos. 50 and Subsequent

Fig. & Index No.	Part No.	DESCRIPTION							NO. REQUIRED PER ASSEMBLY
		1	2	3	4	5	6	7	
1-58	5010828-123**	.	.	Screw, Soc. hd. set. 1/2- 13 NC2 x 3/4 in. lg				1	
1-59	5010700-116	.	Screw, Flat hd, 1/4-28 NF3 x 5/8 in. lg						6
	2010840*	.	Drag Arm Assembly						3
	2010869**	.	Drag Arm Assembly						3
1-60	2010840-2*	.	.	Strip, Drag				1	
	2010869-2**	.	.	Strip, Drag				1	
1-61	2010840-3*	.	.	Shoe, Drag				1	
	2010869-3**	.	.	Shoe, Drag				1	
1-62	2010840-101	.	.	Screw, Flat hd, No. 10-32 NF2 x 3/8 in. lg				2	
1-63	2010840-102	.	.	Nut, Spline, No. 10-32				2	
1-64	3010709	.	Drag Ring Control Wheel						1
	2010842	.	Locking Pin Assembly						1
1-65	1010725	.	.	Knob, Locking pin				1	
1-66	2010842-102	.	.	Pin, Dowel, 1/8 diam x 1 in lg				1	
1-67	2010842-103	.	.	Pin, Dowel, 1/8 diam x 3/4 in. lg				1	
1-68	2010841	.	.	Housing, Locking pin				1	
1-69	1010714	.	.	Pin, Locking				1	
1-70	2010842-104	.	.	Spring				1	
1-71	5010700-117	.	Screw, Truss hd, No. 6-32 NC2 x 3/8 in. lg						6

\* Pedestals Serial Nos. 20 to 49 Inclusive

\*\* Pedestals Serial Nos. 50 and Subsequent

Fig. & Index No.	Part No.	DESCRIPTION							NO. REQUIRED PER ASSEMBLY	
		1	2	3	4	5	6	7		
1-72	3010790	.							Outer Casing, Dome	1
1-73	5010700-105	.							Bolt, Hex hd, 1/4 -20 NC2 x 7/16 in. lg	6
1-74	5010700-106	.							Washer, Lock 1/4 in.	6
1-75	5010700-103*	.							Screw, Rd hd, No. 10-32 NF2 x 1/2 in lg	3
	1010870**	.							Screw, Soc hd, cap, 1/4-28, altered	3
1-76	5010700-104*	.							Washer, Plain, No. 10	3
	3010810*	.							Pulley Assembly, Cable	3
	3010873**	.							Pulley Assembly, Cable	3
1-77	3010810-101*	.	.						Screw, Rd hd, No. 10-32 NF2 x 7/8 in. lg	2
	3010873-101**	.	.						Screw, Rd hd, 1/4-20, NE2 x 1 in. lg	2
1-78	3010810-102*	.	.						Washer, Lock, No. 10	2
	3010873-103**	.	.						Washer, Lock, 1/4 S.A.E.	2
1-79	3010810-104*	.	.						Nut, Hex hd, No. 10-32 NF2	2
	3010873-102**	.	.						Nut, Hex hd, 1/4-20, NC2	2
1-80	3010810-103*	.	.						Washer, 3/16 S.A.E.	2
1-81	2010814*	.	.						Pulley	1
	2010874**	.	.						Pulley	1
1-82	2010848	.	.						Cable	1
1-83	3010810-4*	.	.						Spacer	1
	1010871**	.	.						Spacer	1

\* Pedestals Serial Nos. 20 to 49 Inclusive  
 \*\* Pedestals Serial Nos. 50 and Subsequent

080-102-2

Fig. & Index No.	Part No.	DESCRIPTION							NO. REQUIRED PER ASSEMBLY
		1	2	3	4	5	6	7	
1-84	3010810-105*	.	.	Pin, Cotter					1
1-85	3010810-2*	.	.	Side Plate					2
	2010872**	.	.	Side Plate					2
1-86	5010700-114	.		Screw, Flat hd, 1/4-20 NC2 x 1/2 in. lg					6
1-87	5010700	.		Screw, Set, cup pt 1/4-28 NF2 x 3/8 in. lg					3
1-88	5010700	.		Nut, Hex 1/4-28, NF2					3
	3010850-2	.		Roller Assembly, Tube guide					2
1-89	2010852-2	.	.	Roller					1
1-90	1010860	.	.	Pin					1
1-91	2010854-2	.	.	Bracket					1
	2010851	.		Roller Assembly, Key					1
1-92	1010853	.	.	Roller, Tube guide key					1
1-93	1010856	.	.	Bolt, Roller					1
1-94	2010855	.	.	Bracket, Key roller					1
1-95	2010761-1	.		Counterweight					15
1-96	2010761-2	.		Counterweight					1
1-97	2010761-3	.		Counterweight					1
1-98	4010724	.		Column, Outer					2
1-99	5010821	.		Clamp, Outer column					6
1-100	5010702-109	.		Bolt, Hex hd, 3/8-16, NC2 x 7/8 in. lg					6
1-101	5010702-110	.		Washer, Shakeproof lock, Type 12, 3/8 in.					6

\* Pedestals Serial Nos. 20 to 49 Inclusive

\*\* Pedestals Serial Nos. 50 and Subsequent

Fig. & Index No.	Part No.	DESCRIPTION							NO. REQUIRED PER ASSEMBLY	
		1	2	3	4	5	6	7		
	3010844	.	.						Weight Box Assembly	1
1-102	3010844-103	.	.	.					Screw, Hex hd, cap, 5/16-24, HF2 x 5/8 in. lg	3
1-103	3010844-102	.	.	.					Washer, Plain, 5/16 in. I.D. x 1-5/16 in. O.D.	6
1-104	2010847-2	.	.	.					Stud, Weight box	3
1-105	2010847-1	.	.	.					Stud, Weight box	3
1-106	5010700-101	.	.	.					Bolt, Hex hd, 5/16-18, NC2 x 5/8 in. lg	3
1-107	5010700-102	.	.	.					Washer, 5/16 in.	3
	1010762	.	.	.					Guide Roller Assembly	3
1-108	1010762-1	.	.	.	.				Shaft	1
1-109	1010762-102	.	.	.	.				Washer, Brass, 3/16 I.D. AR x 1/2 O.D. x 0.040 in. thick	1
1-110	1010762-101	.	.	.	.				Bearing, Needle	1
1-111	2010763	.	.	.	.				Bracket, Weight box roller	1
1-112	3010846	.	.	.					Base Plate, Weight box	1
1-113	3010845-4	.	.	.					Base, Weight box	1
1-114	No Number	.							Base Assembly, See figure 2	1



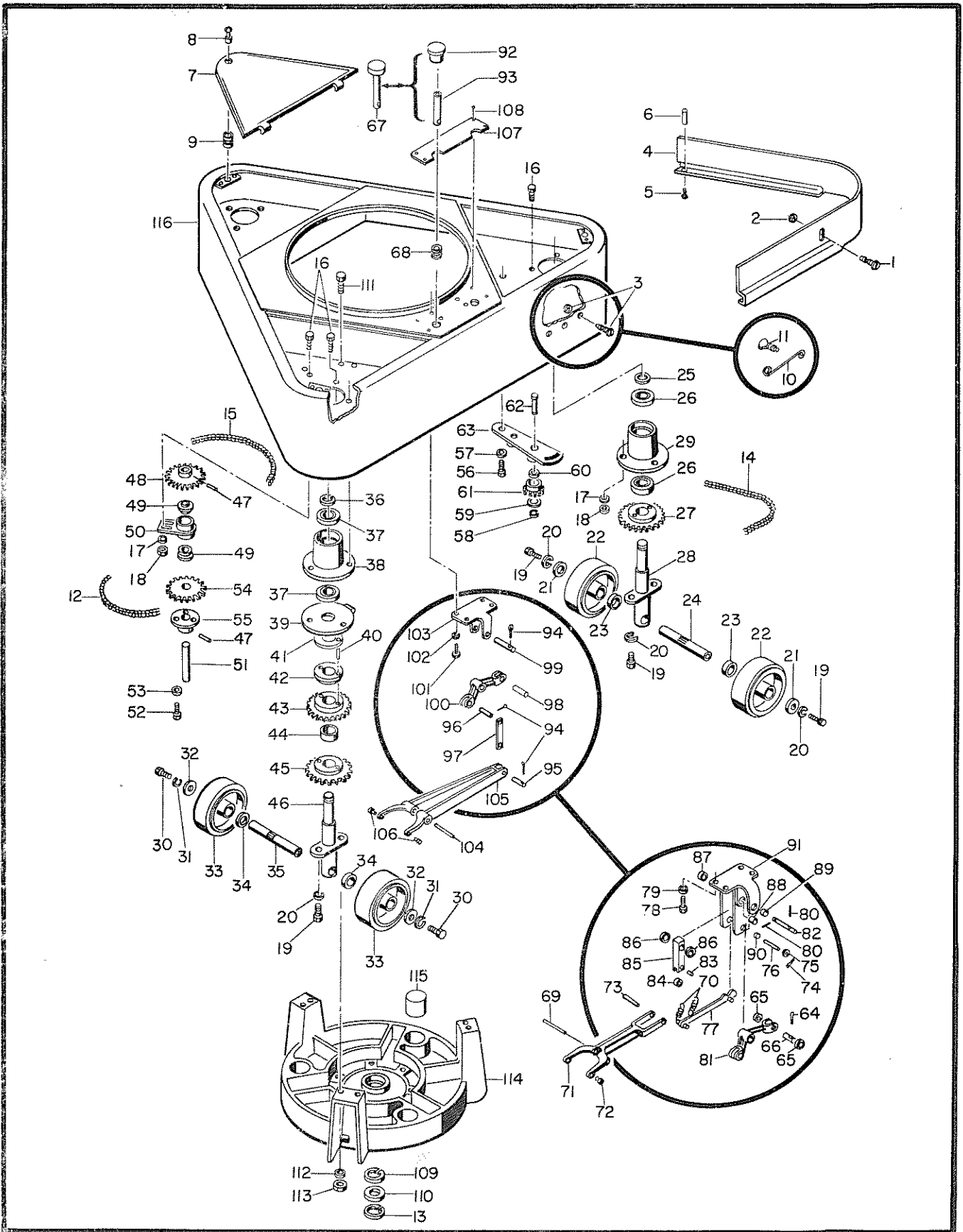

FIGURE 2. HOUSTON-FEARLESS TYPE PD-3 TELEVISION PEDESTAL,  
EXPLODED VIEW, BASE SECTION

Fig. & Index No.	Part No.	DESCRIPTION							NO. REQUIRED PER ASSEMBLY
		1	2	3	4	5	6	7	
2-	No Number	Base Assembly							1
2-1	5010700-108*	.	Fasteners DZUS AJ6-55						6
2-2	5010700-109*	.	Fasteners SX518						6
2-3	5010700-122**	.	Fasteners, Southco #17-11-104-11						6
2-4	4010773	.	Cable guard						3
2-5	5010700-107	.	Screw, Flat hd, 5/16-18 x 5/8 in. lg						6
2-6	1010861	.	Guide, Cable guard						6
2-7	3010772	.	Deck Plate Assembly						3
2-8	3010772-102	.	.	Stud, DZUS Fastener					1
2-9	3010772-103	.	.	Spring, DZUS Fastener					1
2-10	5010700-110*	.	Fastener, DZUS						6
2-11	5010700-111*	.	Screw, Rd hd, No. 5-40 NC2 x 3/16 in. lg						12
2-12	5010700-112	.	Chain, 3/8 pitch x 37-1/2 in. lg						1
2-13	5010700-113	.	Snap Ring						1
2-14	5010702-112	.	Chain, 3/8 pitch x 109-1/8 in lg						1
2-15	5010702-113	.	Chain, 3/8 pitch x 24-3/4 in. lg						1
2-16	5010702-101	.	Bolt, Hex hd, 5/16-24 NF3 x 7/8 in. lg						11
2-17	5010702-102	.	Washer, Shakeproof lock 5/16 in						8
2-18	5010702-103	.	Bolt, Hex, 5/16-24 NF2						8
	3010704	.	Follower Wheel Assembly						2

\* Pedestals Serial Nos. 20 to 49 Inclusive  
 \*\* Pedestals Serial Nos. 50 and Subsequent

Fig. & Index No.	Part No.	DESCRIPTION							NO. REQUIRED PER ASSEMBLY
		1	2	3	4	5	6	7	
2-19	3010704-105	.	.			Screw, Hex hd cap, 1/4-28 NF3 x 3-5/8 in. lg			4
2-20	3010704-106	.	.			Washer, Spring lock, 1/4 in.			4
2-21	1010736	.	.			Washer, Wheel axle			2
2-22	3010704-107	.	.			Wheel			2
2-23	1010734	.	.			Spacer, Wheel			2
2-24	1010739	.	.			Axle, Wheel			1
2-25	3010704-104	.	.			Snap Ring			1
2-26	3010704-101	.	.			Ball Bearings			2
2-27	2010737-2	.	.			Sprocket, Wheel drive			1
2-28	2010776	.	.			Shaft, Wheel			1
2-29	3010731	.	.			Wheel Bearing Housing			1
	3010703	.				Master Wheel Assembly			1
2-30	3010703-105	.	.			Screw, Hex hd cap, 1/4-28 NF3 x 5/8 in. lg			4
2-31	3010703-106	.	.			Washer, Spring lock, 1/4 in.			4
2-32	1010736	.	.			Washer, Wheel axle			2
2-33	3010703-107	.	.			Wheel			2
2-34	1010734	.	.			Spacer, Wheel			2
2-35	1010739	.	.			Axle, Wheel			1
2-36	3010703-104	.	.			Snap Ring			1
2-37	3010703-101	.	.			Ball Bearings			2
2-38	3010731	.	.			Wheel Bearing Housing			1
2-39	3010732	.	.			Plate, Clutch lock			1
	2010775	.	.			Clutch Sprocket Assembly			1

Fig. & Index No.	Part No.	DESCRIPTION							NO. REQUIRED PER ASSEMBLY
		1	2	3	4	5	6	7	
2-40	1010774	.	.	.				Wheel Clutch Sprocket Pin	2
2-41	1010823*	.	.	.				Bumper	2
2-42	2010777	.	.	.				Sprocket Ring	1
2-43	2010738	.	.	.				Wheel Clutch Sprocket	1
2-44	2010775-101	.	.	.				Bearing, Bronze	1
2-45	2010737-1	.	.					Sprocket, Wheel drive	1
2-46	2010776-1	.	.					Shaft, Wheel assembly	1
	2010715	.						Steering Idler Assembly	1
2-47	2010705-101	.	.					Taper Pin, #1 x 1-1/4 in lg	2
2-48	2010748	.	.					Idler Drive sprocket	1
2-49	2010705-102	.	.					Ball Bearings	2
2-50	1010716	.	.					Idler Housing	1
2-51	1010746	.	.					Idler Shaft	1
2-52	2010715-103	.	.					Screw, Hex hd cap, 1/4-28 NF3 x 5/8 in. lg	3
2-53	2010715-104	.	.					Washer Lock, 1/4 in. S.A.E.	3
2-54	2010749	.	.					Sprocket, Idler adjusting	1
2-55	1010747	.	.					Idler Adjusting hub	1
2-56	5010702-108	.						Bolt, Hex hd, 1/4-28 NF3 x1/2 in. lg	7
2-57	5010702-105	.						Washer Shakeproof lock, Type 12, 1/4 in.	2
	2010712	.						Take Up Assembly	1
2-58	2010712-102	.	.					Snap Ring	2

\* Pedestals Serial Nos. 20 to 49 Inclusive

080-102-2

Fig. & Index No.	Part No.	DESCRIPTION							NO. REQUIRED PER ASSEMBLY
		1	2	3	4	5	6	7	
2-59	1010743	.	.	Washer, Idler					2
2-60	2010712-101	.	.	Needle Bearings					2
2-61	1010742	.	.	Idler Sprocket					2
2-62	1010740	.	.	Stud, Idler sprocket					2
2-63	3010741	.	.	Bracket, Idler					2
2-64	5010702-119*	.		Cotter Pin					4
2-65	5010702-121*	.		Washer, Steel, 1/4 in.					4
2-66	1010863*	.		Pin, Clutch pedal					2
2-67	2010717*	.		Pedal, Clutch					2
2-68	5010702-125	.		Rubber Grommet					2
2-69	5010702-116*	.		Pin, 1/4 diam x 1-1/2 in. lg					1
2-70	1010826*	.		Spring, Clutch actuator					2
2-71	3010751*	.		Clutch Actuator					1
2-72	1010758*	.		Shoe, Clutch actuator					2
2-73	1010759*	.		Pin, Spring support					2
2-74	5010702-119*	.		Cotter Pin					2
2-75	5010702-118*	.		Washer, Steel, 7/32 in. I.D.					2
2-76	1010862*	.		Pin, Link					1
2-77	3010754*	.		Link, Clutch arm					1
2-78	5010702-108*	.		Bolt, Hex hd, 1/4-28 NF2 x 1/2 in. lg					4
2-79	5010702-105*	.		Washer, Shakeproof lock, Type 12, 1/4 in.					4

\* Pedestals Serial Nos. 20 to 49 Inclusive

Fig. & Index No.	Part No.	DESCRIPTION							NO. REQUIRED PER ASSEMBLY	
		1	2	3	4	5	6	7		
	3010705	.							Clutch Pedal Assembly	1
2-80	3010705-108*	.	.						Taper Pin, #000, 3/4 in. lg	4
2-81	2010843*	.	.						Rocker Arm, clutch	1
2-82	1010824*	.	.						Shaft, Rocker arm	1
2-83	3010705*	.	.						Pin, Dowel, 3/16 diam x 3/4 in. lg	1
2-84	1010825*	.	.						Roller, Cam actuator	1
2-85	2010755*	.	.						Arm, Cam actuator	1
2-86	3010705-105*	.	.						Washer, 3/8 in. S.A.E.	2
2-87	3010705-107-4*	.	.						Bearing	1
2-88	3010705-107-10*	.	.						Bearing	1
2-89	3010705-107-9*	.	.						Bearing	1
2-90	3010705-109*	.	.						Bushing	2
2-91	3010752*	.	.						Bracket, Support, clutch	1
2-92	1010884**	.							Pedal Assy, Clutch	2
2-93	1010881**	.							Pin, Link, clutch	2
2-94	5010702-119**	.							Pin, Cotter	8
2-95	1010863-2**	.							Pin, Pedal	1
2-96	1010863-1**	.							Pin, Pedal	1
2-97	1010877**	.							Lever, Clutch actuator	1
2-98	1010863**	.							Pin, Pedal	1
2-99	1010885**	.							Pin, Rocker arm	1

\* Pedestals Serial Nos. 20 to 49 Inclusive

\*\* Pedestals Serial Nos. 50 and Subsequent

## 080-102-2

Fig. & Index No.	Part No.	DESCRIPTION							NO. REQUIRED PER ASSEMBLY
		1	2	3	4	5	6	7	
2-100	2010843**	.							1
2-101	5010702-108**	.							4
2-102	5010702-105**	.							4
2-103	3010880**	.							1
2-104	5010702-116**	.							1
2-105	3010879**	.							1
2-106	1010878**	.	.						2
2-107	2010767*	.							1
	2010886**	.							1
2-108	5010702-122	.							4
2-109	5010702-123	.							1
2-110	5010702-124	.							1
2-111	5010702-104	.							6
2-112	5010702-102	.							6
2-113	5010702-106	.							6
2-114	5010720	.							1
2-115	5010702-111	.							3
2-116	4010708	.							1

\* Pedestals Serial Nos. 20 to 49 Inclusive

\*\* Pedestals Serial Nos. 50 and Subsequent